

## WIFI Power Socket

### Features

- Simple Smart Phone or Tablet App
- UK Mains Plug
- WIFI controlled
- 230VAC 10A
- WIFI and Internet control



### Description

The WIFI Smart Socket allows you to control your plug socket from anywhere using your mobile phone. The QFI-SWITCH connects your appliances to the internet so that you can remotely control them from anywhere in the world using your mobile phone.

The Smart Socket allows you to control your application easily with a convenient timer function that can be controlled using a Smart Phone or manually on the socket.

Ideal for applications such as home lighting and other applications with pre-set (ON/OFF) functions.

Part Number	Description	Freq (MHz)	Range** (Metres)
QFI-SWITCH	WIFI 230V MAINS PLUG SWITCH	433	100

## Installation

1. Install the App onto your device.

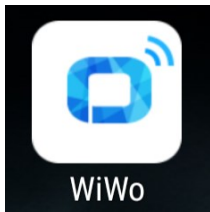

Apple users must search and install “WiWo” from the App Store.  
Android users can download the WiWo App at the link below or by scanning the QR code.

[http://www.orvibo.com/software/download\\_wiwo2.html](http://www.orvibo.com/software/download_wiwo2.html)

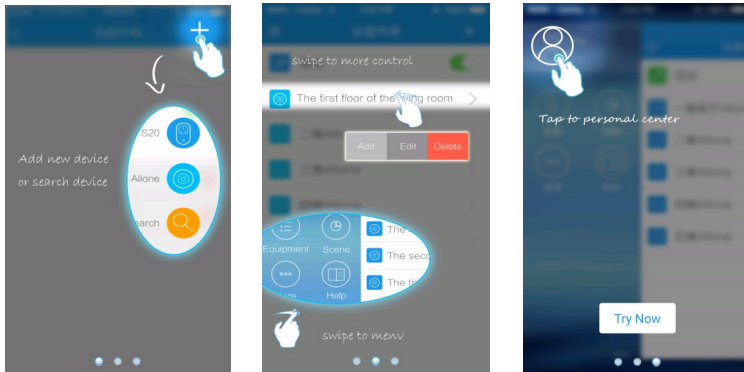
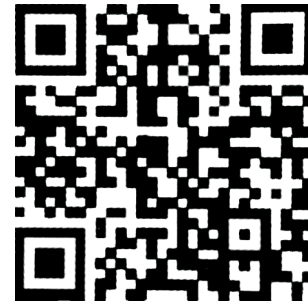

When opening the App for the first time the above images should show.

2. Plug the device into a socket and switch on.

3.1 Press and hold the on/off button on the Plug for 5 seconds until the button flashes Red.



3.2 Press and hold the on/off button on the Plug for 5 seconds until the button changes to flash Blue.



3.3 Go to smart device settings

3.4 (IOS only) go to WiFi settings and select “WiWo-S20”.

3.5 Open the WiWo App.

3.6 Tap the symbol >>>  Device List +

3.7 Select More from the menu.

3.8 Select Ap configuration.

3.9 Select your WiFi router or modem from the menu.

3.10 Enter the Router Password.

3.11 Tap Ok.

3.12 After your plug button turns Red, Assign a new plug socket to the App.



## Assigning a new Plug socket

4.1 <<< tap the symbol

4.2 <<< then tap the next symbol

4.3 Enter WiFi password and click the Configuration button.

4.4 A 60 second countdown will begin to register the plug socket.

4.5 once the registration is complete the phone will show that registration has been successful and display the socket in the menu.

### Operation



When Plug socket is Off



When Plug socket is On

**Note:** For further functionality such as timers please see the manual included with the product.

## Technical Specifications

Electrical Characteristics	Min	Typical	Max	Units
Supply Voltage	100	230	230	V
Max load			10 2200	A W
Operating frequency		2.4		GHz

Dimensions: 103mm x 63mm x 36mm (plus Socket Pins)

#### Disclaimer:

Whilst the information in this document is believed to be correct at the time of issue, QuasarUK Ltd does not accept any liability whatsoever for its accuracy, adequacy or completeness. No express or implied warranty or representation is given relating to the information contained in this document. QuasarUK Ltd reserves the right to make changes and improvements to the product(s) described herein without notice. Buyers and other users should determine for themselves the suitability of any such information or products for their own particular requirements or specification(s). QuasarUK Ltd shall not be liable for any loss or damage caused as a result of user's own determination of how to deploy or use R F Solutions Ltd's products. Use of QuasarUK Ltd products or components in life support and/or safety applications is not authorised except with express written approval. No licences are created, implicitly or otherwise, under any of QuasarUK Ltd's intellectual property rights. Liability for loss or damage resulting or caused by reliance on the information contained herein or from the use of the product (including liability resulting from negligence or where QuasarUK Ltd was aware of the possibility of such loss or damage arising) is excluded. This will not operate to limit or restrict QuasarUK Ltd's liability for death or personal injury resulting from its negligence